

# PRELIMINARY GRADING PLAN NCRSP - PARCEL 49 MAJOR PROJECT PERMIT STAGE 1 - PARCEL 1 & 5 FREEDOM POINT ROSEVILLE, CA

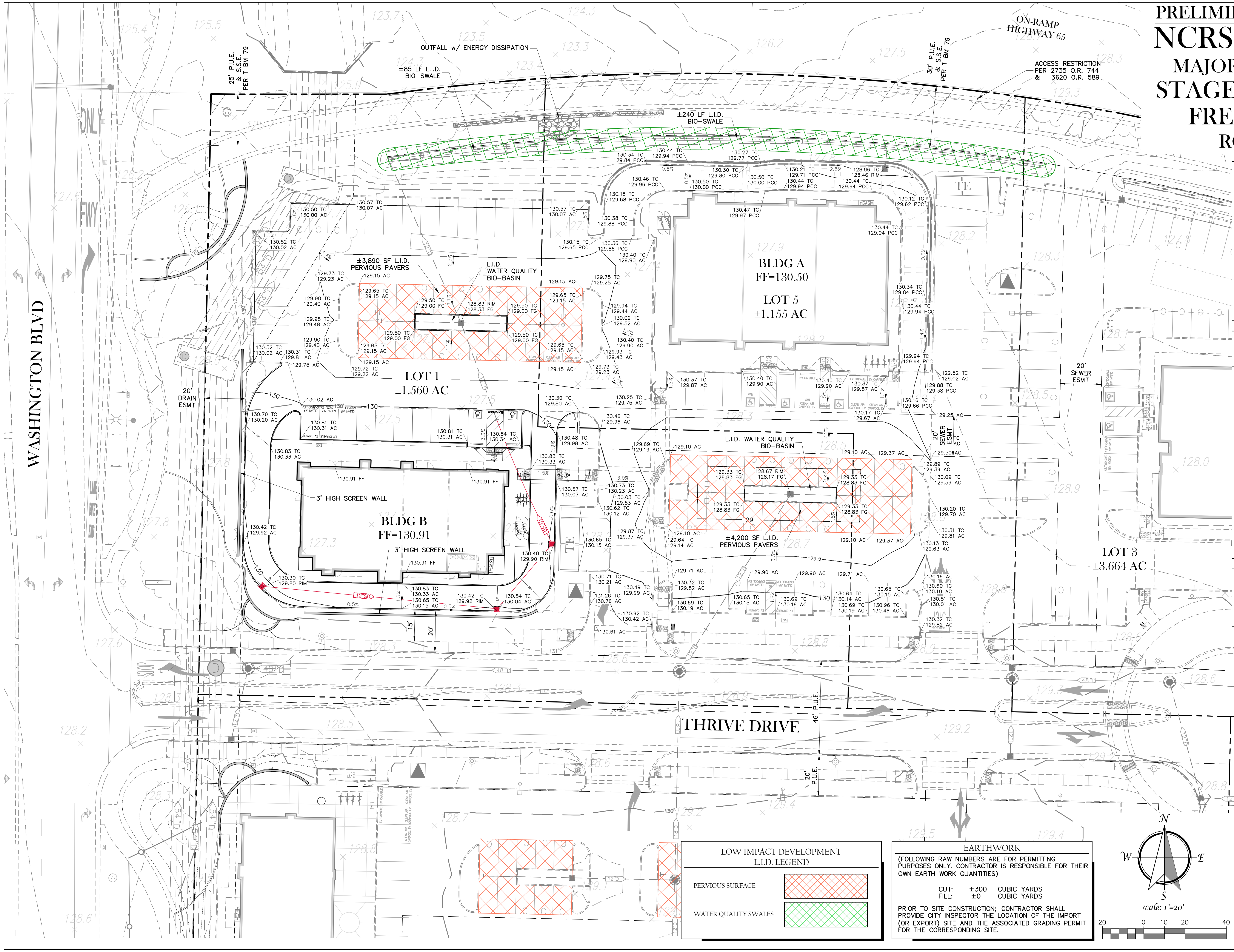

- GRADING NOTES**
1. ALL EXISTING UTILITY LOCATIONS SHOWN ARE APPROXIMATE.
  2. THE PROPOSED UTILITIES AND INFRASTRUCTURE SHOWN ARE CONCEPTUAL ONLY AND ARE SUBJECT TO REVISION.
  3. UTILITIES MAY BE PHASED DEPENDING UPON THE DEVELOPMENT SEQUENCE OF THE PROJECT, SUBJECT TO THE REVIEW OF THE CITY OF ROSEVILLE.
  4. THE EXISTING GROUND CONTOURS SHOWN ON THIS EXHIBIT REPRESENT THE EXISTING GRADE CONDITION AND ARE FOR PLANNING LEVEL STUDIES ONLY.
  5. THE CONCEPTUAL GRADING PLAN IS BASED ON A CONCEPTUAL SITE PLAN AND IS SUBJECT TO CHANGE.
  6. FINAL SITE DESIGN MAY ALTER THE GRADING AND EARTHWORK DESIGN SHOWN HEREON.

**LEGEND**

DESCRIPTION	PROPOSED	EXISTING
DESIGN ELEVATION	130.0 FG	(98.0) FF
CONTOUR	— 130 —	— 130 —
STORM DRAIN		
MANHOLE		
DROP INLET		
WATER QUALITY DEVICE		
GRADE BREAK		
OVERLAND RELEASE		
LANDSCAPE FLOW DIRECTION		
SWALE FLOWLINE		

**FLOOD ZONE**

THIS SITE IS WITHIN ZONE X (AREAS DETERMINED TO BE OUTSIDE THE 500-YEAR FLOODPLAIN) PER THE FEDERAL EMERGENCY MANAGEMENT AGENCY FLOOD INSURANCE RATE MAP, MAP NO. 06061C0413 F, DATED JUNE 8, 1998.

**LOW IMPACT DEVELOPMENT L.I.D. LEGEND**

PERVIOUS SURFACE	
WATER QUALITY SWALES	

**EARTHWORK**

(FOLLOWING RAW NUMBERS ARE FOR PERMITTING PURPOSES ONLY. CONTRACTOR IS RESPONSIBLE FOR THEIR OWN EARTH WORK QUANTITIES)

CUT: ±300 CUBIC YARDS  
FILL: ±0 CUBIC YARDS

PRIOR TO SITE CONSTRUCTION: CONTRACTOR SHALL PROVIDE CITY INSPECTOR THE LOCATION OF THE IMPORT (OR EXPORT) SITE AND THE ASSOCIATED GRADING PERMIT FOR THE CORRESPONDING SITE.

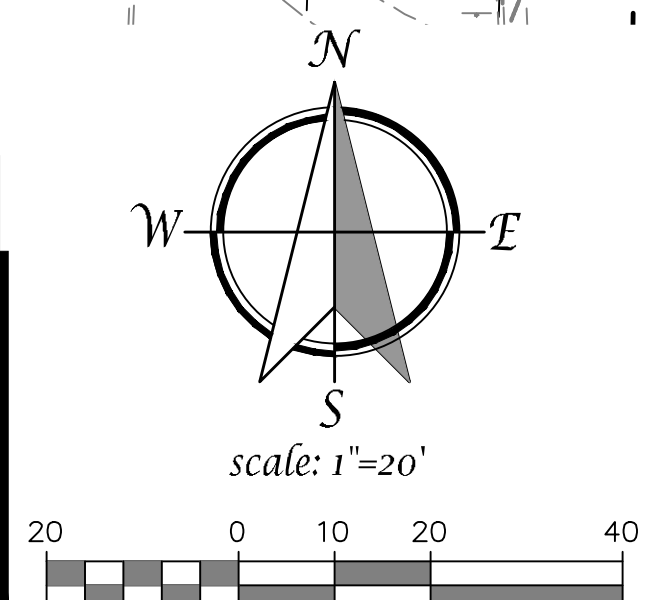

MAJOR PROJECT PERMIT - STAGE 1  
PRELIMINARY GRADING PLAN  
LOT 1 & 5  
FREEDOM POINT RETAIL  
OCTOBER 01, 2019

785 Orchard Drive, Suite #110  
Folsom, CA 95630  
Phone: (916) 608-0707  
Fax: (916) 608-0701

P:\Projects\399-002\02\_DWG\B- Preliminary VTC\51\_Lot 1 - BLDG B - Preliminary Grading Plan.dwg, Dana Moore, 17:16:43, 10-01-19